

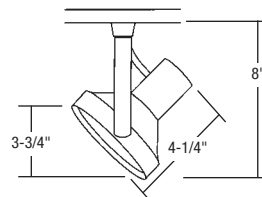

**CTL830 PAR30 Gimbal**

The 2-plane gimbal design permits the maximum horizontal and vertical swivel for excellent aiming, and the "Sure-Set" yoke holds the fixture firmly in place. Supplied with field-mounted accessory clips (FA-38). Integral on/off switch and track polarity indicator are standard. Will accept FA-38 clips and one LF20 lens.

Max. Lamp: 75W PAR30S, E26 Medium Base, 120V  
 Finish: - B, P, U, US (Grey Track Adapter and Black Cord)



**CTL2830 PAR30 Front Relamping Gimbal**

The 2-plane gimbal design permits the maximum horizontal and vertical swivel for excellent aiming, and the "Sure-Set" yoke holds the fixture firmly in place. Integral on/off switch and track polarity indicator are standard. Front lamp loading ease. Will accept FA-28 clips and one LF30 lens.

Max. Lamp: 75W PAR30S, Short Neck, E26 Medium Base, 120V  
 Finish: - B, P, S

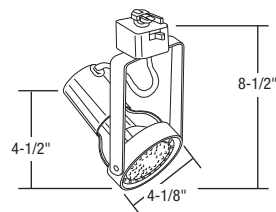

**CTL838 PAR38 Gimbal - Heavy Duty**

The 2-plane gimbal design permits the maximum horizontal and vertical swivel for excellent aiming, and the "Sure-Set" yoke holds the fixture firmly in place. Supplied with spring clips for the use of accessories such as colored lenses and/or egg crate louvers. PAR38 medium base lamp. Integral on/off switch and track polarity indicator are standard. Will accept two LF38 lenses.

Max. Lamp: 250W PAR38, E26 Medium Skirted Base, 120V  
 Finish: - B, P

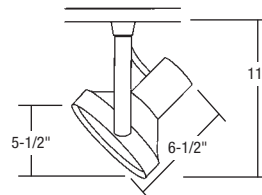

**CTL838/2 PAR38 Gimbal - Slim Style**

The 2-plane gimbal design permits the maximum horizontal and vertical swivel for excellent aiming, and the "Sure-Set" yoke holds the fixture firmly in place. Supplied with field-mounted accessory clips (FA-38). PAR38 medium base lamp. Integral on/off switch and track polarity indicator are standard. Will accept FA-38 clips and one LF30 lens.

Max. Lamp: 250W PAR38, E26 Medium Skirted Base, 120V  
 Finish: - B, P, U

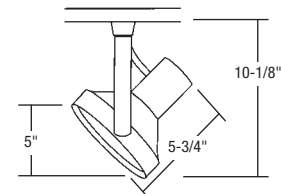

\*For use on other manufacturer's track systems, see page 112.

Fixture Finish Codes

- B - Black
- P - White
- S - Silver
- U - UNLook
- US - Satin UNLook

# Incandescent Fixture/Accessory Compatibility Chart

	Accessory Holder	Amber Lens	Blue Lens	Clear Lens	Green Lens	Light Blue Lens	Red Lens	Rose Lens	Yellow Lens	Prismatic Spread Lens	Linear Spread Lens	Soft Light Lens	Optivex UV Lens	Louwer	Barn Door
CTL120	FA-20	LF20-A	LF20-B	LF20-CL	LF20-G	LF20-LB	LF20-R	LF20-RO	LF20-Y	LF20-73	LF20-LS	LF20-SL	LF20-UV	LA-37	BD20
CTL130	FA-30	LF30-A	LF30-B	LF30-CL	LF30-G	LF30-LB	LF30-R	LF30-RO	LF30-Y	LF30-73	LF30-LS	LF30-SL	LF30-UV	LA-38	BD30
CTL140	FA-40	LF40-A	LF40-B	LF40-CL	LF40-G	LF40-LB	LF40-R	LF40-RO	LF40-Y	LF40-73	LF40-LS	LF40-SL	LF40-UV	LA-39	BD40
CTL2116	FAH-16	LF18-A	LF18-B	LF18-CL	LF18-G	LF18-LB	LF18-R	LF18-RO	LF18-Y	LF18-73	LF18-LS	LF18-SL	LF18-UV	LA-35	BD16
CTL2120	FA-20	LF20-A	LF20-B	LF20-CL	LF20-G	LF20-LB	LF20-R	LF20-RO	LF20-Y	LF20-73	LF20-LS	LF20-SL	LF20-UV	LA-37	BD20
CTL2130	FA-30	LF30-A	LF30-B	LF30-CL	LF30-G	LF30-LB	LF30-R	LF30-RO	LF30-Y	LF30-73	LF30-LS	LF30-SL	LF30-UV	LA-38	BD30
CTL2140	FA-40	LF40-A	LF40-B	LF40-CL	LF40-G	LF40-LB	LF40-R	LF40-RO	LF40-Y	LF40-73	LF40-LS	LF40-SL	LF40-UV	LA-39	BD40
CTL2216	FAH-16	LF18-A	LF18-B	LF18-CL	LF18-G	LF18-LB	LF18-R	LF18-RO	LF18-Y	LF18-73	LF18-LS	LF18-SL	LF18-UV	LA-35	BD16
CTL220	FA-20	LF20-A	LF20-B	LF20-CL	LF20-G	LF20-LB	LF20-R	LF20-RO	LF20-Y	LF20-73	LF20-LS	LF20-SL	LF20-UV	LA-37	BD20
CTL2220	FA-20	LF20-A	LF20-B	LF20-CL	LF20-G	LF20-LB	LF20-R	LF20-RO	LF20-Y	LF20-73	LF20-LS	LF20-SL	LF20-UV	LA-37	BD20
CTL2230	FA-30	LF30-A	LF30-B	LF30-CL	LF30-G	LF30-LB	LF30-R	LF30-RO	LF30-Y	LF30-73	LF30-LS	LF30-SL	LF30-UV	LA-38	BD30
CTL2240	FA-40	LF40-A	LF40-B	LF40-CL	LF40-G	LF40-LB	LF40-R	LF40-RO	LF40-Y	LF40-73	LF40-LS	LF40-SL	LF40-UV	LA-39	BD40
CTL230	FA-30	LF30-A	LF30-B	LF30-CL	LF30-G	LF30-LB	LF30-R	LF30-RO	LF30-Y	LF30-73	LF30-LS	LF30-SL	LF30-UV	LA-38	BD30
CTL240	FA-40	LF40-A	LF40-B	LF40-CL	LF40-G	LF40-LB	LF40-R	LF40-RO	LF40-Y	LF40-73	LF40-LS	LF40-SL	LF40-UV	LA-39	BD40
CTL2820	FA-28	LF20-A 86MM	LF20-B 86MM	LF20-CL 86MM	LF20-G 86MM	LF20-LB 86MM	LF20-R 86MM	LF20-RO 86MM	LF20-Y 86MM	LF20-73 86MM	LF20-LS 86MM	LF20-SL 86MM	LF20-UV 86MM		
CTL2830	FA-28	LF30-A	LF30-B	LF30-CL	LF30-G	LF30-LB	LF30-R	LF30-RO	LF30-Y	LF30-73	LF30-LS	LF30-SL	LF30-UV	LA-38	
CTL2838N	FA-2838	LF40-A	LF40-B	LF40-CL	LF40-G	LF40-LB	LF40-R	LF40-RO	LF40-Y	LF40-73	LF40-LS	LF40-SL	LF40-UV	LA-39	
CTL330	FA-30	LF30-A	LF30-B	LF30-CL	LF30-G	LF30-LB	LF30-R	LF30-RO	LF30-Y	LF30-73	LF30-LS	LF30-SL	LF30-UV	LA-38	BD30
CTL340	FA-40	LF40-A	LF40-B	LF40-CL	LF40-G	LF40-LB	LF40-R	LF40-RO	LF40-Y	LF40-73	LF40-LS	LF40-SL	LF40-UV	LA-39	BD40
CTL500DEWW	LA-70									LF-70-73	LF-70-LS	LF-70-SL	LF-70-UV	LA-71	BD70
CTL5030 (With Accessory Holder)	FA-30	LF30-A	LF30-B	LF30-CL	LF30-G	LF30-LB	LF30-R	LF30-RO	LF30-Y	LF30-73	LF30-LS	LF30-SL	LF30-UV	LA-38	BD30
CTL5030 (Within Aperture Sleeve)		LF20-A	LF20-B	LF20-CL	LF20-G	LF20-LB	LF20-R	LF20-RO	LF20-Y	LF20-73	LF20-LS	LF20-SL	LF20-UV	LA-37	
CTL5038 (With Accessory Holder)	FA-40	LF40-A	LF40-B	LF40-CL	LF40-G	LF40-LB	LF40-R	LF40-RO	LF40-Y	LF40-73	LF40-LS	LF40-SL	LF40-UV	LA-39	BD40
CTL5038 (Within Aperture Sleeve)		LF38-A	LF38-B	LF38-CL	LF38-G	LF38-LB	LF38-R	LF38-RO	LF38-Y	LF38-73	LF38-LS	LF38-SL	LF38-UV		
CTL520	FA-20	LF20-A	LF20-B	LF20-CL	LF20-G	LF20-LB	LF20-R	LF20-RO	LF20-Y	LF20-73	LF20-LS	LF20-SL	LF20-UV	LA-37	BD20
CTL5256		LF56-A	LF56-B	LF56-CL	LF56-G	LF56-LB	LF56-R	LF56-RO	LF56-Y	LF56-73	LF56-LS	LF56-SL	LF56-UV	LA-56	BD56
CTL530	FA-30	LF30-A	LF30-B	LF30-CL	LF30-G	LF30-LB	LF30-R	LF30-RO	LF30-Y	LF30-73	LF30-LS	LF30-SL	LF30-UV	LA-38	BD30
CTL540	FA-40	LF40-A	LF40-B	LF40-CL	LF40-G	LF40-LB	LF40-R	LF40-RO	LF40-Y	LF40-73	LF40-LS	LF40-SL	LF40-UV	LA-39	BD40
CTL600															BD60
CTL600 (With LA-30 PAR30 Lamphshade)	FA-30	LF30-A	LF30-B	LF30-CL	LF30-G	LF30-LB	LF30-R	LF30-RO	LF30-Y	LF30-73	LF30-LS	LF30-SL	LF30-UV	LA-38	BD30
CTL600 (With LA-40 PAR38 Lamphshade)	FA-40	LF40-A	LF40-B	LF40-CL	LF40-G	LF40-LB	LF40-R	LF40-RO	LF40-Y	LF40-73	LF40-LS	LF40-SL	LF40-UV	LA-39	BD40
CTL601															BD60
CTL610 (With LA620 PAR20 Shade)	FA-37	LF20-A 86MM	LF20-B 86MM	LF20-CL 86MM	LF20-G 86MM	LF20-LB 86MM	LF20-R 86MM	LF20-RO 86MM	LF20-Y 86MM	LF20-73 86MM	LF20-LS 86MM	LF20-SL 86MM	LF20-UV 86MM		
CTL610 (With LA630 PAR30 Shade)	FA-37A	LF30-A	LF30-B	LF30-CL	LF30-G	LF30-LB	LF30-R	LF30-RO	LF30-Y	LF30-73	LF30-LS	LF30-SL	LF30-UV	LA-38	
CTL610 (With LA6838 PAR38 Shade)	FA-37B	LF40-A	LF40-B	LF40-CL	LF40-G	LF40-LB	LF40-R	LF40-RO	LF40-Y	LF40-73	LF40-LS	LF40-SL	LF40-UV	LA-39	
CTL6130	FA-37A	LF30-A	LF30-B	LF30-CL	LF30-G	LF30-LB	LF30-R	LF30-RO	LF30-Y	LF30-73	LF30-LS	LF30-SL	LF30-UV	LA-38	
CTL8020	FA-20	LF20-A	LF20-B	LF20-CL	LF20-G	LF20-LB	LF20-R	LF20-RO	LF20-Y	LF20-73	LF20-LS	LF20-SL	LF20-UV	LA-37	BD20
CTL8030	FA-30	LF30-A	LF30-B	LF30-CL	LF30-G	LF30-LB	LF30-R	LF30-RO	LF30-Y	LF30-73	LF30-LS	LF30-SL	LF30-UV	LA-38	BD30
CTL8038	FA-40	LF40-A	LF40-B	LF40-CL	LF40-G	LF40-LB	LF40-R	LF40-RO	LF40-Y	LF40-73	LF40-LS	LF40-SL	LF40-UV	LA-39	BD40
CTL830	FA-38	LF20-A	LF20-B	LF20-CL	LF20-G	LF20-LB	LF20-R	LF20-RO	LF20-Y	LF20-73	LF20-LS	LF20-SL	LF20-UV	LA-36 Without Accessory Holder; LA-37 with FA-38	BD830
CTL838		LF38-A	LF38-B	LF38-CL	LF38-G	LF38-LB	LF38-R	LF38-RO	LF38-Y	LF38-73	LF38-LS	LF38-SL	LF38-UV	LA-38	BD38
CTL838/2	FA-38	LF30-A	LF30-B	LF30-CL	LF30-G	LF30-LB	LF30-R	LF30-RO	LF30-Y	LF30-73	LF30-LS	LF30-SL	LF30-UV	LA-38	BD38
CTL9020	FA-9020	LF20-A	LF20-B	LF20-CL	LF20-G	LF20-LB	LF20-R	LF20-RO	LF20-Y	LF20-73	LF20-LS	LF20-SL	LF20-UV		